

# Eagles Mere Country Club

## Course Construction – 1911 - 1923

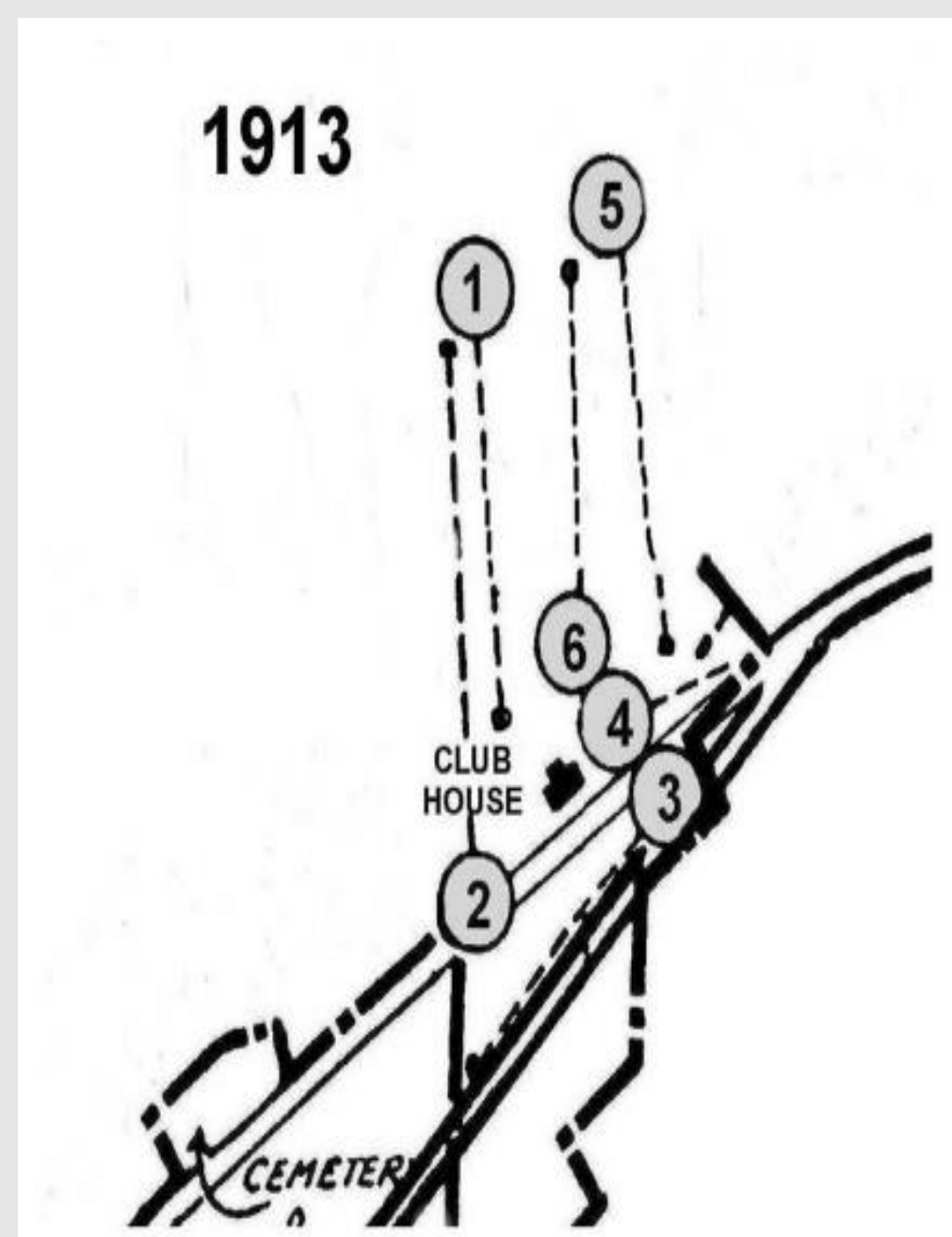

The initial holes were opened in 1913 and play as our current 1, 2, 3, 4, 5 and 18.

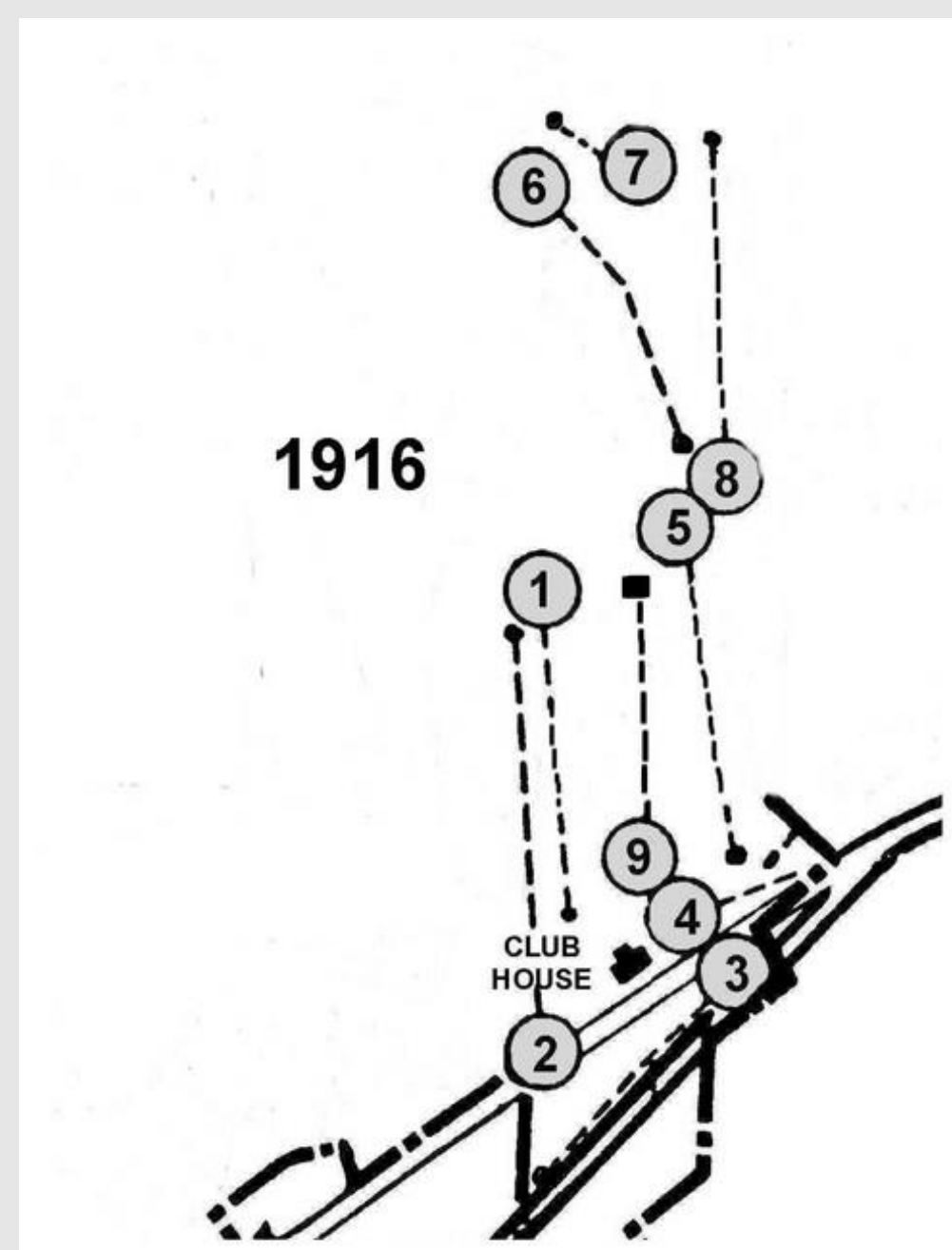

By 1916, Flynn added three more holes, that we play today as 6, 7 and 16, to complete a 9-hole course.

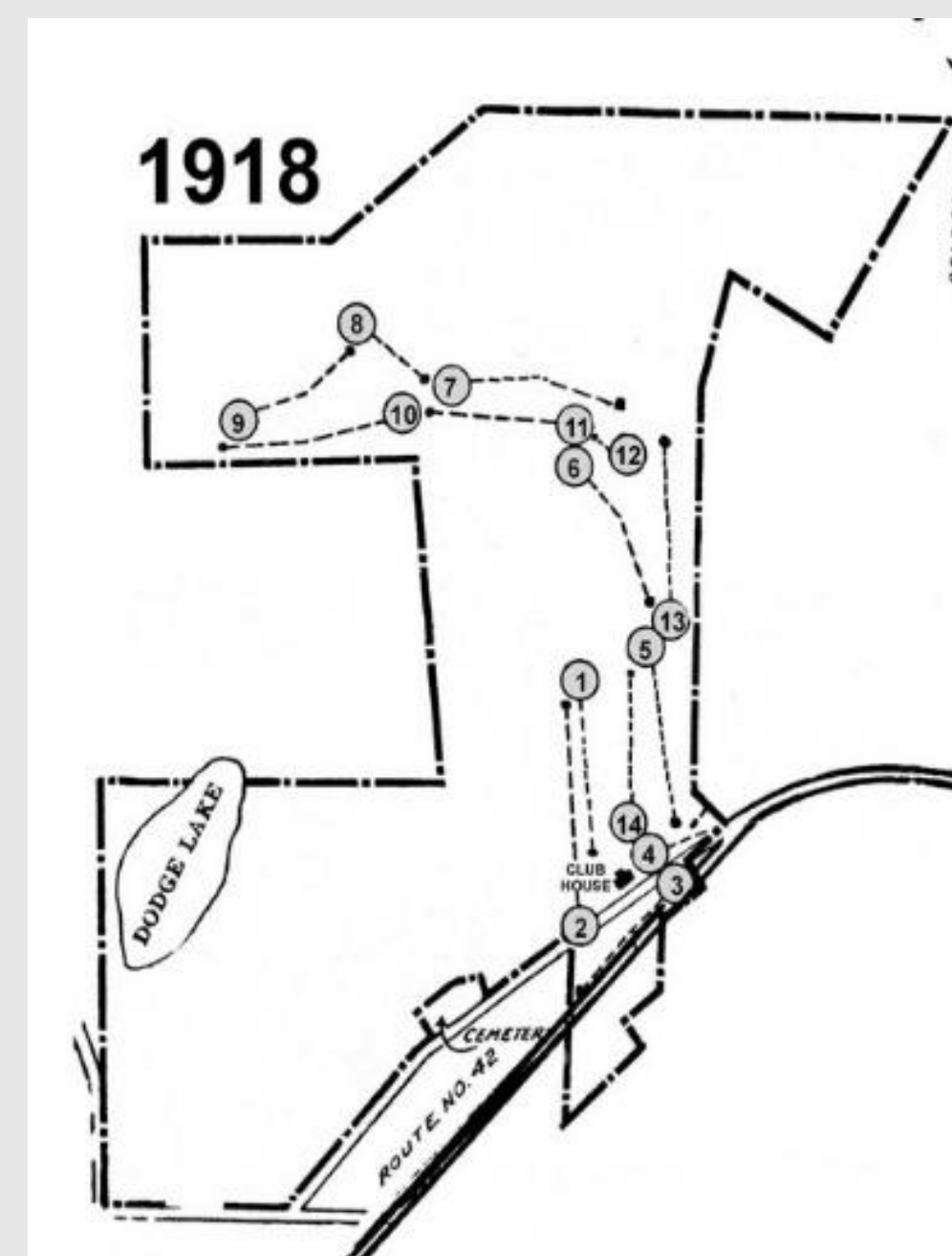

Flynn then completed four more holes by 1918 that we play today as 12, 13, 14 and 15.

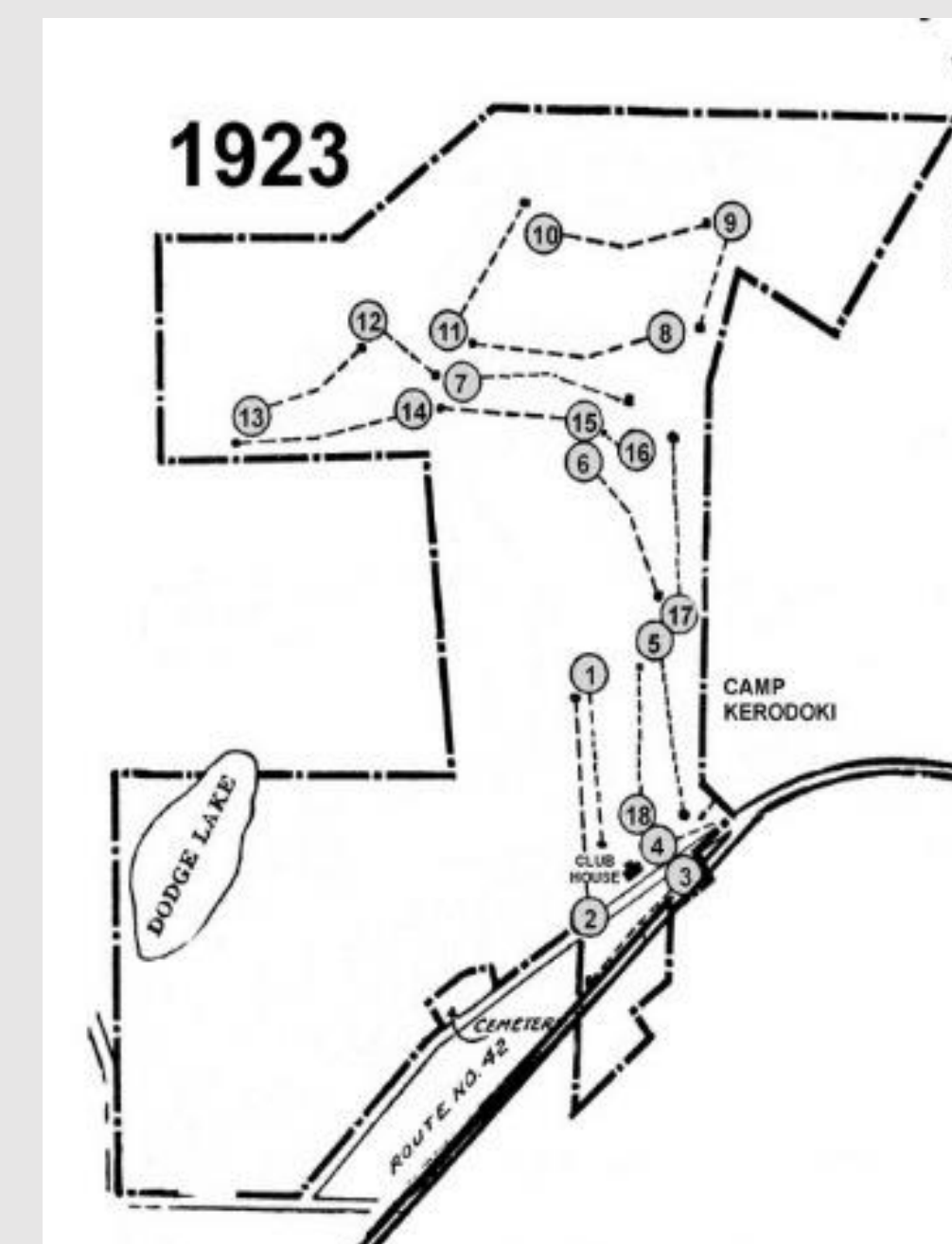

The final four holes were completed by 1923 with the addition of what we play today as 8, 9, 10, and 11.